

# POWERTEC Generator Set

## Powered by Perkins 1206A-E70TTAG3 Engine

Model: PPE275A    Prime Power: 200KW/250KVA    Standby Power: 220KW/275KVA

### Genset Fundamental Characteristics

- ◆ 230/400VAC, 50HZ 0.8PF 3 Phases, 4 wires output
- ◆ Frequency drop  $\leq 3\%$
- ◆ Voltage modulation  $\leq 0.3\%$
- ◆ The steady state frequency  $\leq 0.5\%$
- ◆ The steady state voltage deviation  $\leq \pm 1\%$
- ◆ The transient frequency deviation  $\leq +10\%$   $\leq -15\%$
- ◆ The transient voltage deviation  $\leq +20\%$   $\leq -15\%$
- ◆ Frequency recovery time  $\leq 3S$
- ◆ Voltage recovery time  $\leq 1S(\text{Voltage} \pm 3\%)$
- ◆ THF (Telephone Harmonic Factor)  $< 3$
- ◆ TIF (Telephone Influence Factor)  $< 50$
- ◆ Comply to Standard NEMA MG1-22.43
- ◆ Standard equipped with ambient temperature  $40^{\circ}C$   
Connecting radiator
- ◆ Inbuilt shock absorber has high performance on shock absorption.  
It's easy to be transported and installed without embedding and  
Fixing rubber shock pad between the genset and ground

### Genset Standard Configuration

- ◆ Perkins Engine
- ◆ Brushless synchronous alternator
- ◆ POWERTEC intelligent controller
- ◆  $40^{\circ}C$  standard ambient temperature  
Water radiator
- ◆ Modularized case circuit breaker (3P)
- ◆ Float Battery Charger
- ◆ Battery connect wire
- ◆ Steel base frame(include shock absorbers )
- ◆ Bottom oil tank
- ◆ Bellows、exhaust bend
- ◆ Manual book and files

### Genset Optional Configuration

- ◆ 24V Starter Batteries
- ◆ Daily Fuel Tank
- ◆ Oil-water separator
- ◆ Warning function of low water level, low fuel oil
- ◆ Automatically monitoring & controlling system of city power
- ◆ Coolant heater
- ◆ Oil heater
- ◆ Heat exchanger--Water cooling Tower System
- ◆ Soundproof Canopy/ Trailer
- ◆ ISO container
- ◆ Design and construction of environmental protection  
Engineering for the Genset room

## Performance Description of Diesel Engine

- ◆ Model: **Perkins 1206A-E70TTAG3**
- ◆ Construction: The 8.8-liter turbocharged engine has a world-class power density; it's able to apply in any market steadily because of Hydraulic Drive Unit (HEUI) injection system, which enables it to accommodate different qualities of fuel around the world.
- ◆ Intake: Turbocharged
- ◆ Fuel system: HEUI fuel system is equipped with full authority electronic control; electronic governor is adjustable to ISO8528-5 standard, with independent constant speed and load distribution function
- ◆ Lubrication system: Wet all aluminum oil pan with injector and dip stick
- ◆ Cooling system: Constant temperature control cooling system, belt drive circulating pump and belt drive fan; embedded belt drive push rod fan; independent radiator, air to air inter cooler
- ◆ Filtration system: Embedded air filter; Fuel filter; Spinning primary, secondary filter and water filter; Spinning full-flow oil filter
- ◆ Electrical equipment: 24V starter and 24V, 45A alternator (DC output); electronic control module ECM (installed on the engine and equipped with wire insulation sleeve and inductor)
- ◆ Lower operating cost: The standard replacement oil interval is set to 500 hours
- ◆ Engine Operating Environment Description:  
The engine can work under the following conditions without modulating power:  
1800r/min engine--altitude less than 1000 m, ambient temperature less than 40 °C  
1500r/min engine--altitude less than 1000 m, ambient temperature less than 40 °C



## Performance Description Alternator

- ◆ Optional Alternator: **Stamford / Marathon/ Faraday/Engga/Mecc Alt**
- ◆ Brushless, 4 pole rotating magnetic field, single bearing with protective cover
- ◆ Insulation: H Class.
- ◆ Standard IP23 grade
- ◆ Cooling system
- ◆ AC exciter, rotate rectifying unit
- ◆ Surface of stator winding is covered with damp-proof epoxy Insulation varnish after impregnation proceeding
- ◆ Rotor and exciter is proceeded with high temperature insulating resin, Will be more applicable for harsh environment.
- ◆ Rotor dynamic balancing comply to standard BS5625, class 2.5
- ◆ Sealed with advanced lubricating grease prolongs life of bearing.



**Notes: Above data of alternator comes from Stamford. Proper specification is subject to the practice alternator if customers choose other alternator**

## Standard Detection Function

- ◆ 3 phases voltage  $U_a, U_b, U_c$
- ◆ Frequency  $F_1$
- ◆ Apparent power  $PR$
- ◆ Coolant temperature  $WT$
- ◆ Oil pressure  $OP$
- ◆ Speed  $RPM$
- ◆ HC timer 99999 hours records
- ◆ Maximum cumulative times of starting can reach 999999
- ◆ 3 phases current  $I_a, I_b, I_c$
- ◆ Active power  $PA$
- ◆ Power factor  $PF$
- ◆ Temperature  $^{\circ}C$  display
- ◆  $KPa/Psi/Bar$  display
- ◆ Battery voltage  $V$



## Standard Protection Function

### Genset Protection

- ◆ Programmable alarm and status input
- ◆ Emergency stop

### Engine Protection

- ◆ Stop for over speed
- ◆ Alarm/Stop for low oil pressure
- ◆ Alarm/Stop for coolant high temperature
- ◆ Stop for failure to start/jigger
- ◆ Indication of sensor fault
- ◆ Alarm for low/high battery voltage
- ◆ Alarm for shortage of battery

### Alternator Protection

- ◆ Stop for over high/low voltage
- ◆ Alarm/stop for over current
- ◆ Stop for loss of voltage detection signal
- ◆ Stop for over frequency
- ◆ Stop for low frequency

### Control System Components

- ◆ Control switch—manual/auto/stop/start
- ◆ Screen menu selection button
- ◆ Setting button
- ◆ Fault status indicators
- ◆ Emergency stop button
- ◆ Digital display



## Communication Interface

(optional function)

- ◆ International standard MODBUS communication protocol with error detection as well as RS232/ RS485 (RS485 is opto-isolated type) has functions of remote control, telemetry and telesignalling, which are facilitate to monitor genset.

**Notes:** Above data of controller comes from POWERTEC GC6110. Proper specification is subject to customers' practice controller if other controller is selected.

Genset	Model	PPE275A
	Prime Rating (kw)	200
	Standby Rating (kw)	220
	Prime current(A)	360
	Frequency(hz)	50
Engine & Alternator	Engine Model	1206A-E70TTAG3
	Gross Engine output-Prime (kw)	226
	Gross Engine output-Standby (kw)	248
	Bore * stroke (mm)	105*135
	Cylinders and structure	6 In line
	Displacement(Liter)	7.01
	Compression Ratio	15.8:1
	Intake way	Turbocharged/ Air-Air intercooler
	Max intake resistance (KPa)	8
	Air intake (m3/h)	846
	Max exhaust back pressure (KPa)	10
	Exhaust gas flow (m3/h)	2250
	Exhaust temp (°C)	537
	Cooling way	Water Radiator & Fan
	Fan exhaust flow (m3/min)	369.6
	Coolant capacity (L)	29.6
	Highest water temperature(°C)	112
	Minimum air opening to room (m2)	1.8/1.6
	Thermostat range (°C)	85-95
	Max oil temperature (°C)	125
	Lubrication system oil capacity (L)	16
	Fuel consumption(L/H)	56.9
	Standard Governor/Class	Electronic
	Optional Alternator Model	Marathon--- MP-217-4A Engga----- EG280-200N Stamford---- UCDI 274K Faraday----- FD3H1-4
	Rated Voltage(V)	400/230
	Output Way	3 Phases, 4 wires
	Rated power factor	0.8
	Exciter	Brushless, Self-exciter
	Max voltage regulation	±1%
	Phase	3
Protection class	IP21-23	
Insulation class	H	
Controller	Brand and Model	POWERTEC GC6110

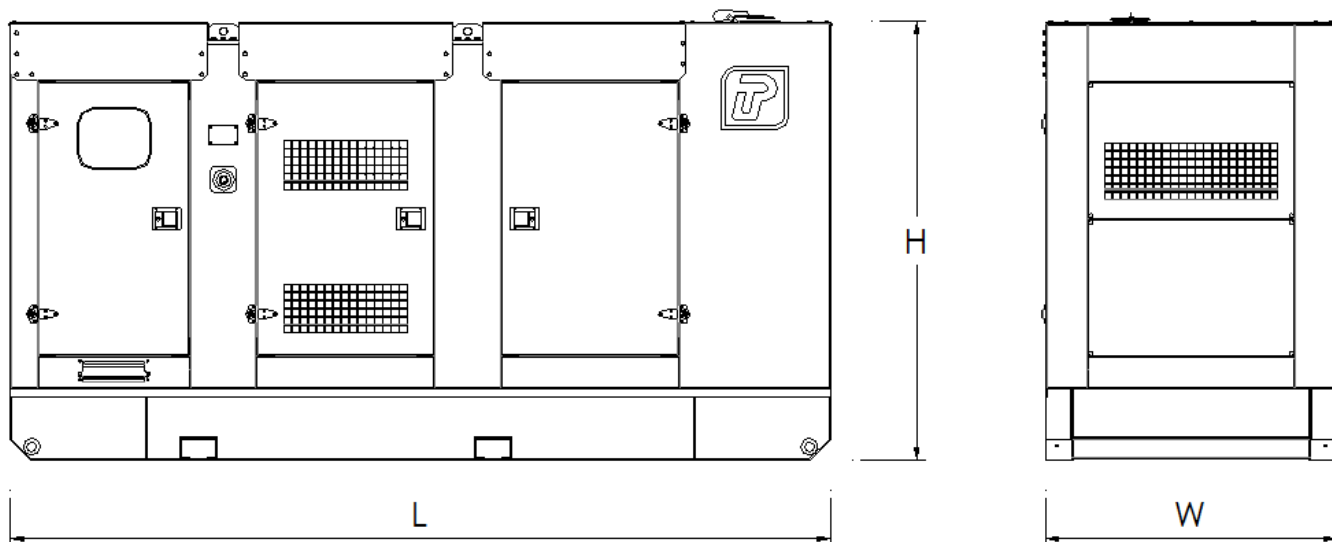
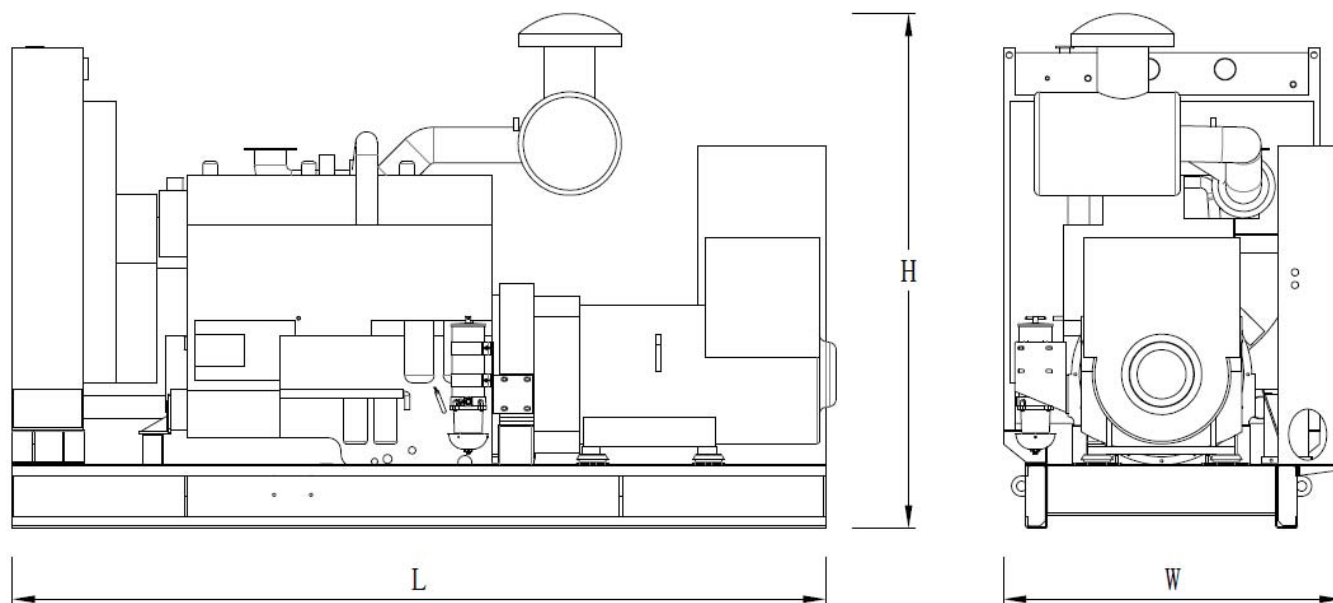

Type	Dimension mm (L*W*H)	Weight KG	Fuel Tank Capacity L
Open Type	2900*1230*1830	2300	430
Silent Type	3950*1400*2115	3700	600

Notes:: Above data are for reference only. Specific size is subjected to actual measurement.

## Contact Way

## Powertec Generator System Co., Ltd

Add: Danshui Yanna Industry Zone, Huiyang, Huizhou, Guangdong, China

Tel: 0752-3911119 / 0752-3911118

FAX: 0752-3911110

Web: [www.powertec.com.cn](http://www.powertec.com.cn) Email: [sales@powertecgs.com](mailto:sales@powertecgs.com)