

PPE375B

Prime Power:275KW/344KVA Standby Power:300KW/375KVA Voltage: 400VAC

Powered by Perkins1706A-E93TAG2 Engine

Genset Performance

- 230/400VAC, 50Hz, 0.8PF, 3 Phases 4 wires
- Frequency drop $\leq 3\%$
- Voltage regulation $\leq 0.3\%$
- The steady state frequency $\leq 0.5\%$
- The steady state voltage deviation $\leq \pm 1\%$
- The transient frequency deviatio $\leq +10\%$ $\leq -15\%$
- The transient voltage deviation $\leq +20\%$ $\leq -15\%$
- Frequency recovery time $\leq 3S$
- Voltage recovery time $\leq 1S(\text{Voltage} \pm 3\%)$
- THF (Telephone Harmonic Factor) < 3
- TIF (Telephone Influence Factor) < 50
Comply to Standard NEMA MG1-22.43
- Built-in vibration isolator with high performance on shock absorption.

Standard Configuration

- Perkins Engine
- Brushless synchronous alternator
- POWERTEC intelligent controller
- 40°C standard ambient temperature
(50°C Optional)
- Molded case circuit breaker (3P)
- Float battery charger
- Battery connect wire
- Steel base frame
- Silencer, bellows, exhaust bend
- Manual book and files

Optional Items

- Starting batteries
- Fuel tank
- Oil-water separator
- Sensor for low coolant level, low fuel/oil level
- Automatically monitoring & controlling system of city power
- Coolant heater
- Oil heater
- Heat exchanger--Water cooled tower system
- Soundproof canopy
- Trailer
- 20GP or 40HQ container type canopy
- Design and construction of environmental protection
- Engineering for the Genset room

Diesel Engine

- Model: Perkins 1706A-E93TAG2
- Construction: Forged steel crankshaft, cast iron steel body and Replaceable wet cylinder liner, two/four valves per cylinder ;
- Cooling system: Thermostatically-controlled system with belt driven coolant pump and pusher fan; mounted radiator, piping and guards;
- Fuel system: Mechanically regulated embedded fuel injection pump, non-direct injection ;

Environment: The engine can work under the following conditions without modulating power:

1800r/min engine--altitude less than 1000 m, ambient temperature less than 40 °C

1500r/min engine--altitude less than 1000 m, ambient temperature less than 40 °C

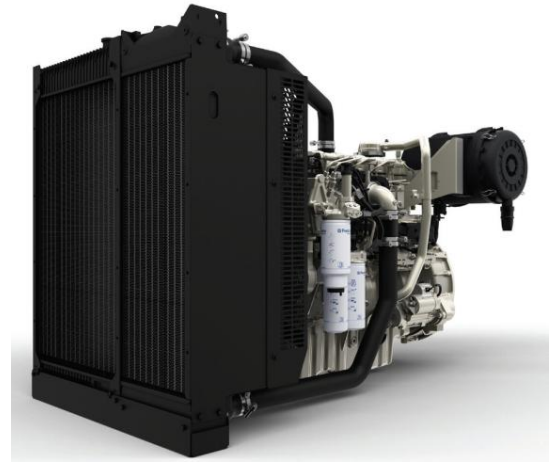

Alternator

- Optional brands: **Stamford / Marathon / Faraday / Engga / Mecc Alt**
- Brushless, 4 pole rotating magnetic field, single bearing with protective cover.
- Insulation: H Class.
- IP Class: IP23
- Cooling system
- AC exciter, rotate rectifying
- Rotor and exciter made with high temperature insulating resin, to satisfy tough environment.
- Rotor dynamic balancing complys for BS5625, class 2.
- Sealed with advanced lubricating grease to prolong life of bearing.



Notes: Above data of alternator comes from Stamford. Specification may alternated without advance notice.

Standard

- 3 phases voltage: Ua, Ub, Uc
- Frequency F1
- Apparent power PR
- Power factor PF
- Coolant temperature WT
- Temperature °C display
- Oil pressure OP
- Engine speed
- 3 phases current: La, Lb, Lc
- Active power PA
- Power factor PF
- Temperature °C display
- KPa/Psi/Bar display
- Battery voltage V
- Running Hour
- Starting timer:(999999)



Standard Protection

Genset Protection

- Programmable I/O signal
- Emergency stop

Engine Protection

- Stop for over speed
- Low oil pressure
- High Coolant temperature
- Sensor fail
- Alarm for low/high battery voltage
- Low battery voltage
- Fail to start/Cranking fail

Alternator Protection

- Over Voltage
- Over current
- Voltage signal lost
- Over Voltage
- Over frequency
- Under frequency

Control System Components

- Manual/auto/stop/start
- Setting button
- Fault status indicators
- Screen menu selection button
- Emergency stop button
- Digital displayer



Communication Interface (Option)

- International standard MODBUS communication protocol RS232/ RS485 is suitable for remote control and monitor; It is easy integrated with SCADA;.

Notes: Above data of controller comes from POWERTEC GC6110. Customized solutions is available as required

Genset

Model	PPE375B
Prime Rating (kw)	275
Standby Rating (kw)	300
Rate voltage(V)	400
Rate current(A)	496
Power factor	0.8
Frequency(Hz)	50

Engine

Engine Model	1706A-E93TAG2
Gross Engine output-Prime (kw)	302
Gross Engine output-Standby (kw)	334
Bore * stroke (mm)	115*149
Cylinders and structure	6 In line
Displacement(Liter)	9.29
Compression Ratio	16.5:1
Intake way	Supercharge / Air to air intercooled
Max intake resistance (KPa)	8
Air intake (m3/h)	1150
Max exhaust back pressure (KPa)	10
Exhaust gas flow (m3/h)	2860
Exhaust temp (°C)	550
Cooling way	Water Radiator & Fan
Fan exhaust flow (m3/min)	369.6
Coolant capacity (L)	33
Highest water temperature(°C)	112
Minimum air opening to room (m2)	2.0/1.8
Thermostat range (°C)	83-92
Max oil temperature (°C)	125
Lubrication system oil capacity (L)	30
Rate load fuel consumption(L/H)	80
Standard Governor/Class	Electronic

Alternator

Rated Voltage(V)	400/230
Output Way	3 Phases, 4 wires
Rated power factor	0.8
Exciter	Brushless, Self-exciter
Max voltage regulation	±1%
Phase	3
Protection class	IP21-23
Insulation class	H

Controller

Brand	POWERTEC or DEEPSEA
-------	---------------------

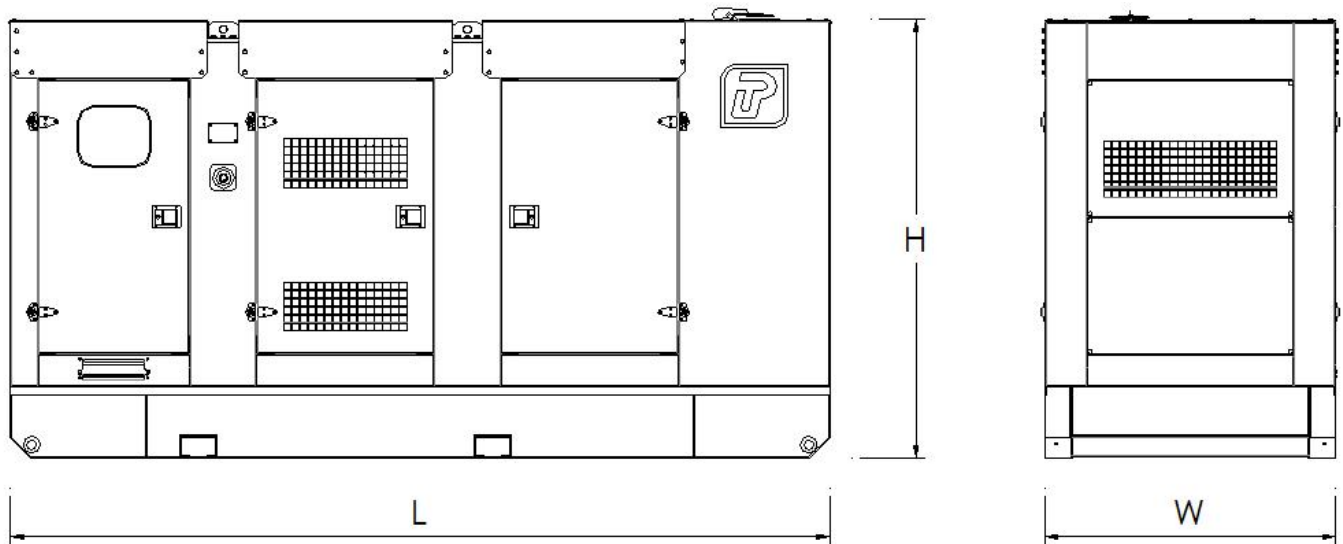
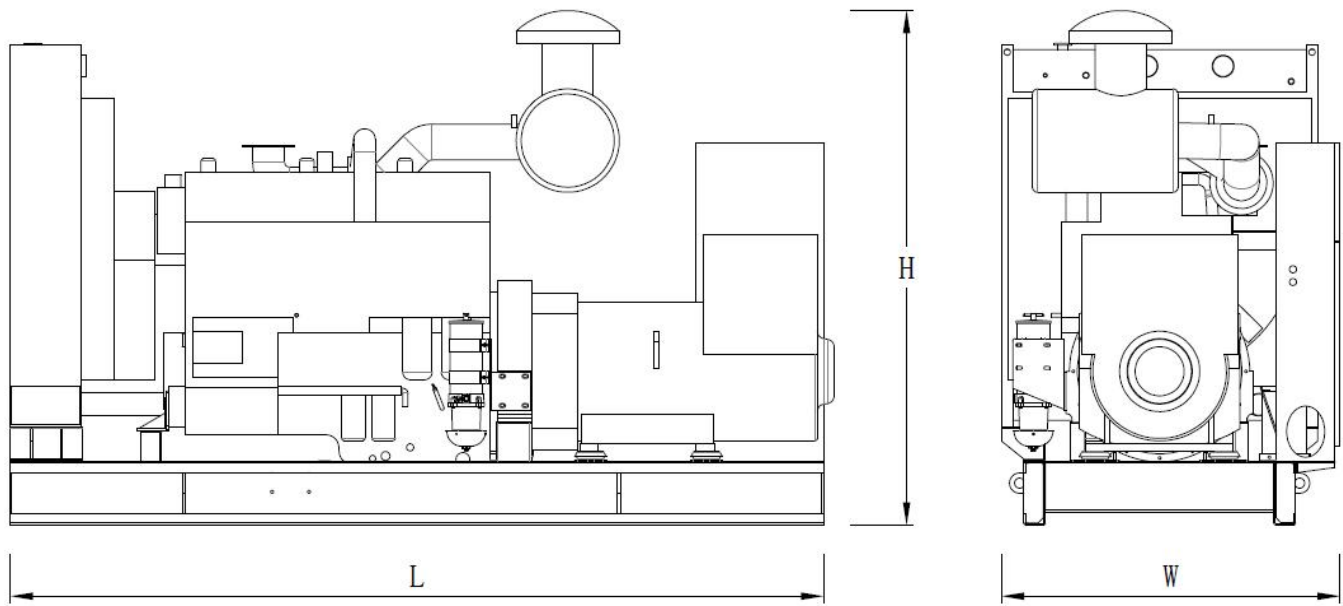

Type	Dimension (mm) (L*W*H)	Weight (kg)	Fuel Tank Capacity (L)
Open Type	3000*1330*1750	2550	-
Silent Type	3950*1400*2115	3950	600

Contact Us

Powertec Generator System Co., Ltd

Add: Danshui Yanna Industry Zone, Huiyang, Huizhou, Guangdong, China
Tel: +86 752-3911119 / 3911118
Fax: +86 752-3911110
Web: www.powertec.com.cn
Email: powertec@powertec.com.cn